

BLOCK D: FOUNDATION LAYOUT PLAN
scale 1:75

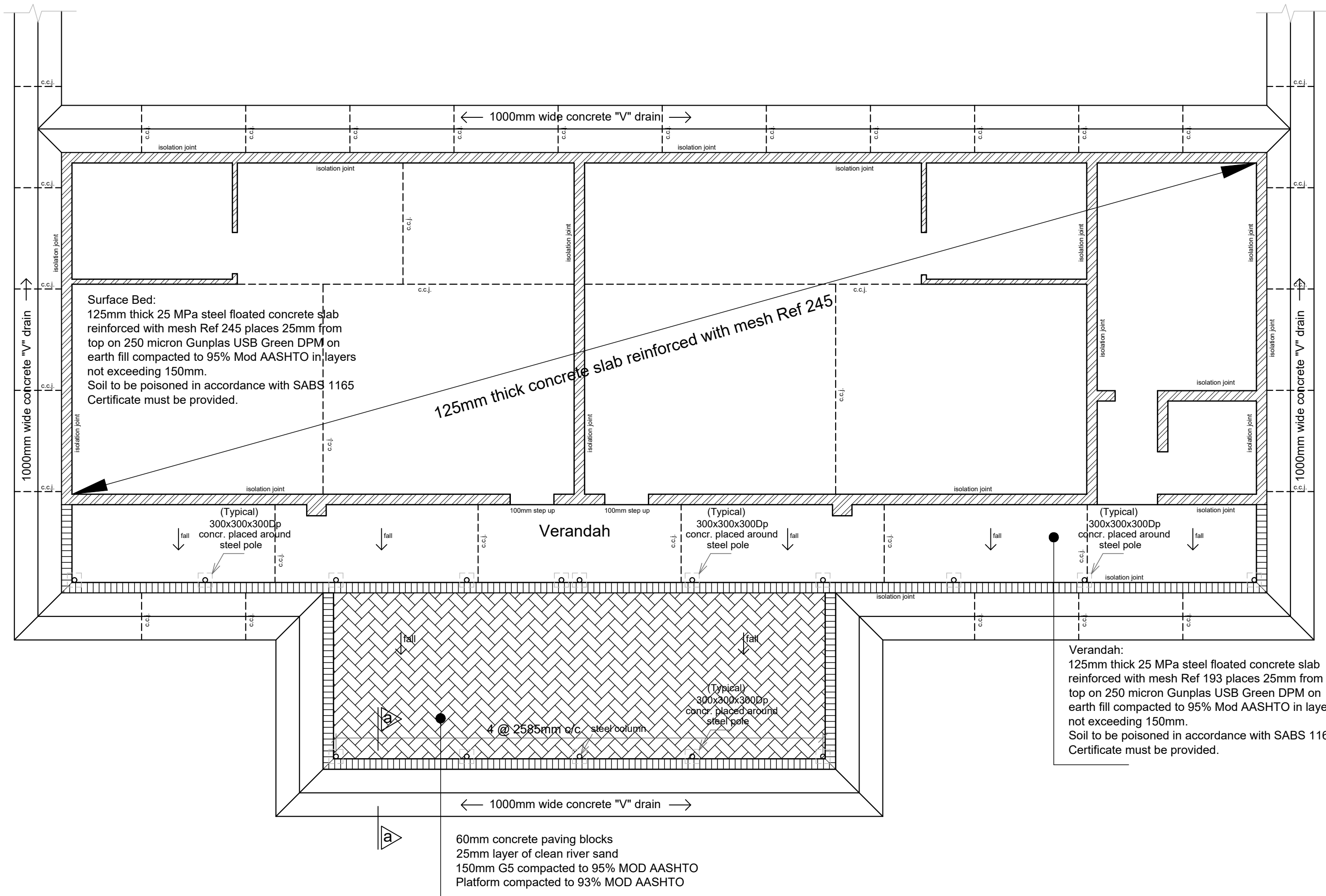

BLOCK D: SURFACE BED SLAB, VERANDAH,
WALKWAY AND 'V' DRAIN LAYOUT PLAN
scale 1:75

NOTES:
SAW CUT JOINTS TO BE SAWN WITHIN
24hrs OF PLACING CONCRETE

DPM WATERPROOFING NOTE

DPM: ONE LAYER OF 250 MICRON DPM WATERPROOFING SHEETING BEARING SABS 952-1985 TYPE C. THE SHEETING SHALL BE LAID IN THE WIDEST PRACTICAL WIDTHS TO MINIMIZE JOINTS AND SHALL BE TURNED UP, DRESSED TO WALLS AND LAPPED WITH BRIKGRIP SABS DPC.

ALL JOINTS SHALL BE SEALED WITH THE BLACK PRESSURE SENSITIVE TAPE APPLIED OVER THE LEADING EDGE OF THE JOINT, MIN LAP 150MM.

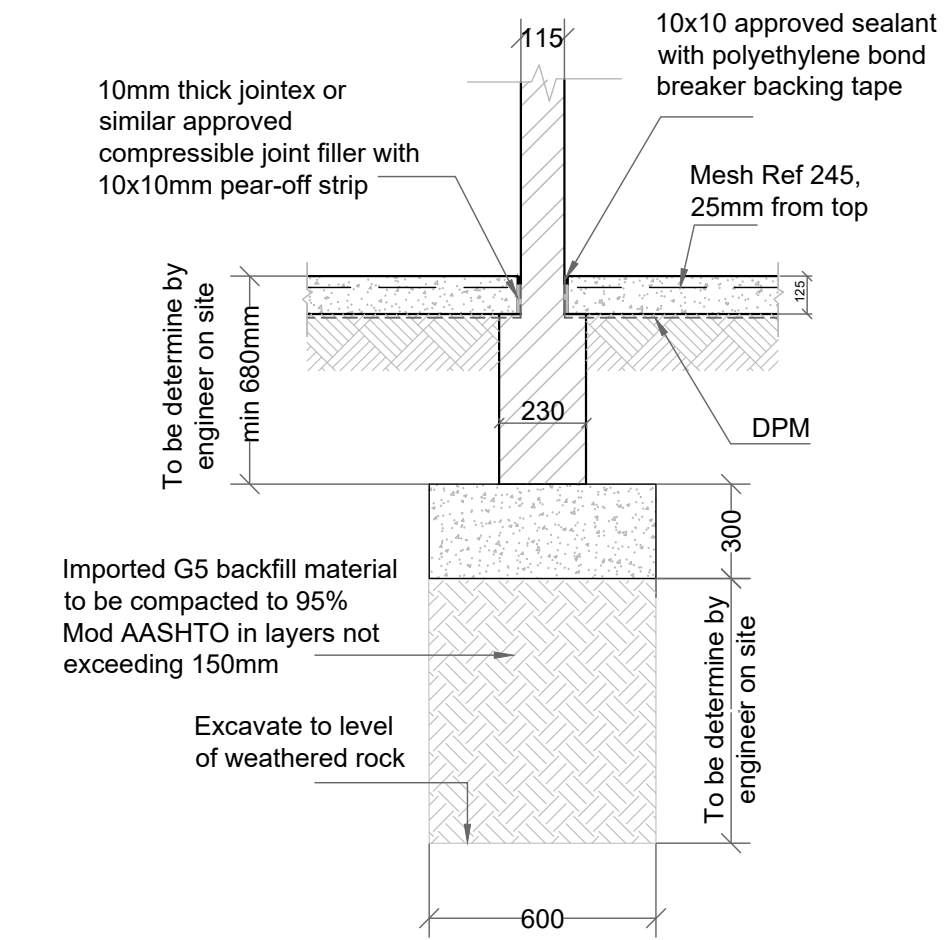

STRIP FOOTING (TYPICAL)
(internal walls)
SCALE 1:20

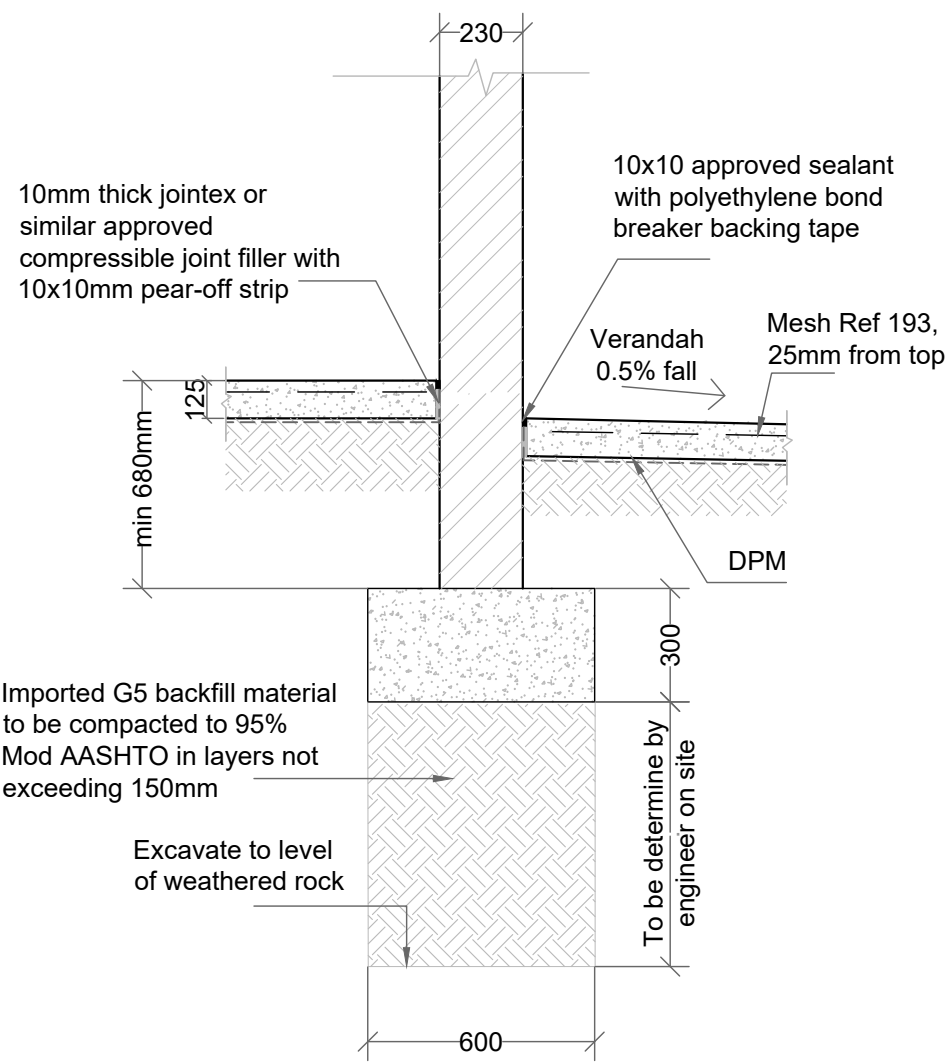

SECTION a-a
Scale 1:20

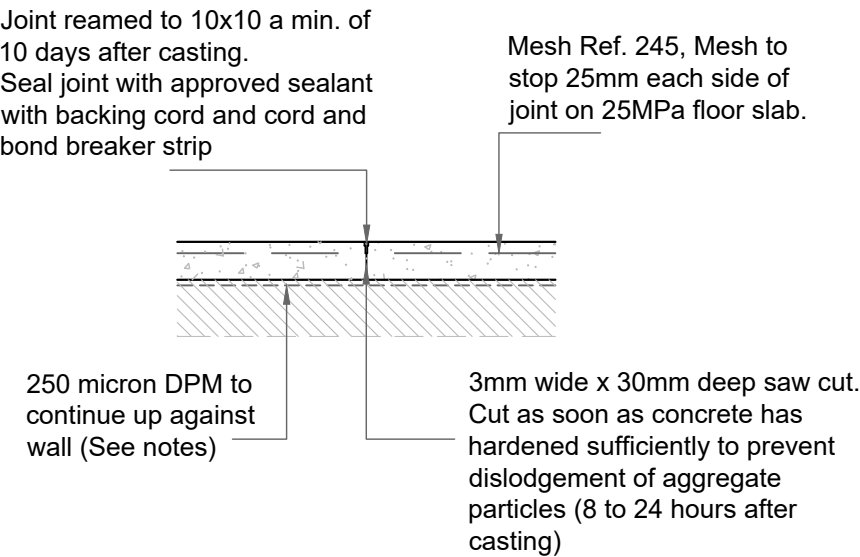

CRACK CONTROL JOINT (C.C.J.)
scale 1:20

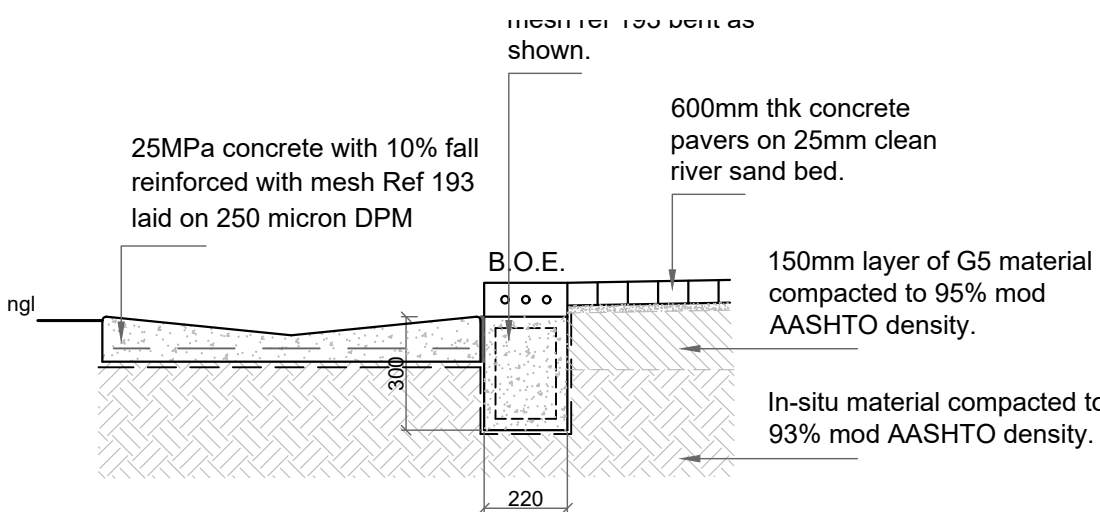

SECTION a-a scale 1:20

ISOLATION JOINT (I.J.) scale 1:20

NOTES:

- DRAWINGS ARE NOT TO BE SCALED.
- POSITION OF CONCRETE RAIN WATER CHANNELS ARRANGEMENT TO BE RECONFIGURED ON SITE.
- POSITIONS OF RAMPS TO BE DETERMINED BY PROJECT ARCHITECT.
- DRAWING TO BE READ WITH ARCHITECTURAL DRAWING.

REVISIONS

	DATE	DESCRIPTION
A	19/08/2022	STAGE 4 APPROVAL

CLIENT:



IMPLEMENTING AGENT:



PROJECT MANAGERS:
CIVIL ENGINEERS:
STRUCTURAL ENGINEERS:



PROJECT NAME & CLIENT INFORMATION
STORM DAMAGE PROGRAMME:
EXHAPHOZINI PRIMARY SCHOOL
DBSA

SECTION / BLOCK
GRADE R CLASSROOM BLOCK

TITLE
CIVIL ENGINEERING DRAWING

DRAWING DESCRIPTION
FOUNDATION AND SURFACE BED
SLAB LAYOUT PLAN

SCALE	AS SHOWN
DESIGNED SAM	DATE AUG 2022
DRAWN SAM	DATE AUG 2022
APPROVED R.J.K	DATE AUG 2022
	DESIGNED P.Eng No. 20160552
	DRAWN P.Eng No. 20160552
	DRAWN 20060009
DRAWING NUMBER:	P2206/10-03
	REVISION A